

Copyright of this drawing belongs to MP&S Planning & Design Ltd and shall not be used or reproduced in any form without its express permission.

Scale of this drawing - Work to figured dimensions only. All dimensions to be checked on site prior to the execution of any work.

For the avoidance of doubt all dimensions are measured to wall structure and not the finishes unless otherwise stated.

Where any discrepancy is found to exist within or between drawings and/or documents it should be reported to the architect immediately.

MP&S Planning & Design Ltd shall not be liable for any use of drawings and documents for any purpose other than for which the same were prepared by or on behalf of MP&S Planning & Design Ltd.

- KEY**
- Denotes GRP chimney positions
 - Denotes additional windows to the elevation.
 - Denotes affordable housing.

- HIGHWAYS**
- Denotes primary spine street route. 5.5m wide road with 2.0m footpath.
 - Denotes contrasting shared access driveway.
 - Denotes block paving for speed table.
 - Denotes vehicle restraint system. Refer to engineer's drawing for further details.

- BOUNDARY TREATMENTS**
- Denotes 1.8m high reconstituted stone wall.
 - Denotes low wall with timber infill.
 - Denotes 1.8m concrete post & gravel board plot-divisional fence.
 - Denotes 2m high acoustic fence.
 - Denotes retaining wall with 1.1m railings on top. Refer to engineer's drawings for further information.
 - Denotes 1.2m high railing.
 - Denotes 600mm high reconstituted stone wall with piers.
 - Denotes 450mm high knee rail with hedge behind.
 - Denotes bin store. Refer to boundary treatment layout for further information.
 - Denotes access gate position.

- LANDSCAPE**
- Denotes proposed trees.
 - Denotes existing trees / hedges to be retained.

Rev	Date	Revision	Initial
F	23.11.23	Low wall with timber infill added to layout	ac
E	17.11.23	Affordable house types amended & speed table relocated.	ac CW
D	26.10.23	Design meeting comments incorporated.	ac CW
C	10.08.22	Drainage drawing, levels and retaining walls, and access detail updated.	ad ac CW
B	19.07.22	Turning head increased in front of plot 37	ac CW
A	13.07.22	Plot 27/28 changed to Type J.	ac CW



ILLUSTRATIVE SITE LAYOUT

Former Mossley High School, Huddersfield Road, Mossley

Job No	Dwg No	Drawn	Rev
21023	02	AC	F

Scale	Date	Stage
1:500@A2	JULY 2022	FOR PLANNING

mp&s planning & design ltd
4 Bail Green, Cobers Court, Trafford Park, Manchester, M32 0GT
t: 0161 772 1999
e: info@mpdesign.co.uk
www.mpdesign.co.uk

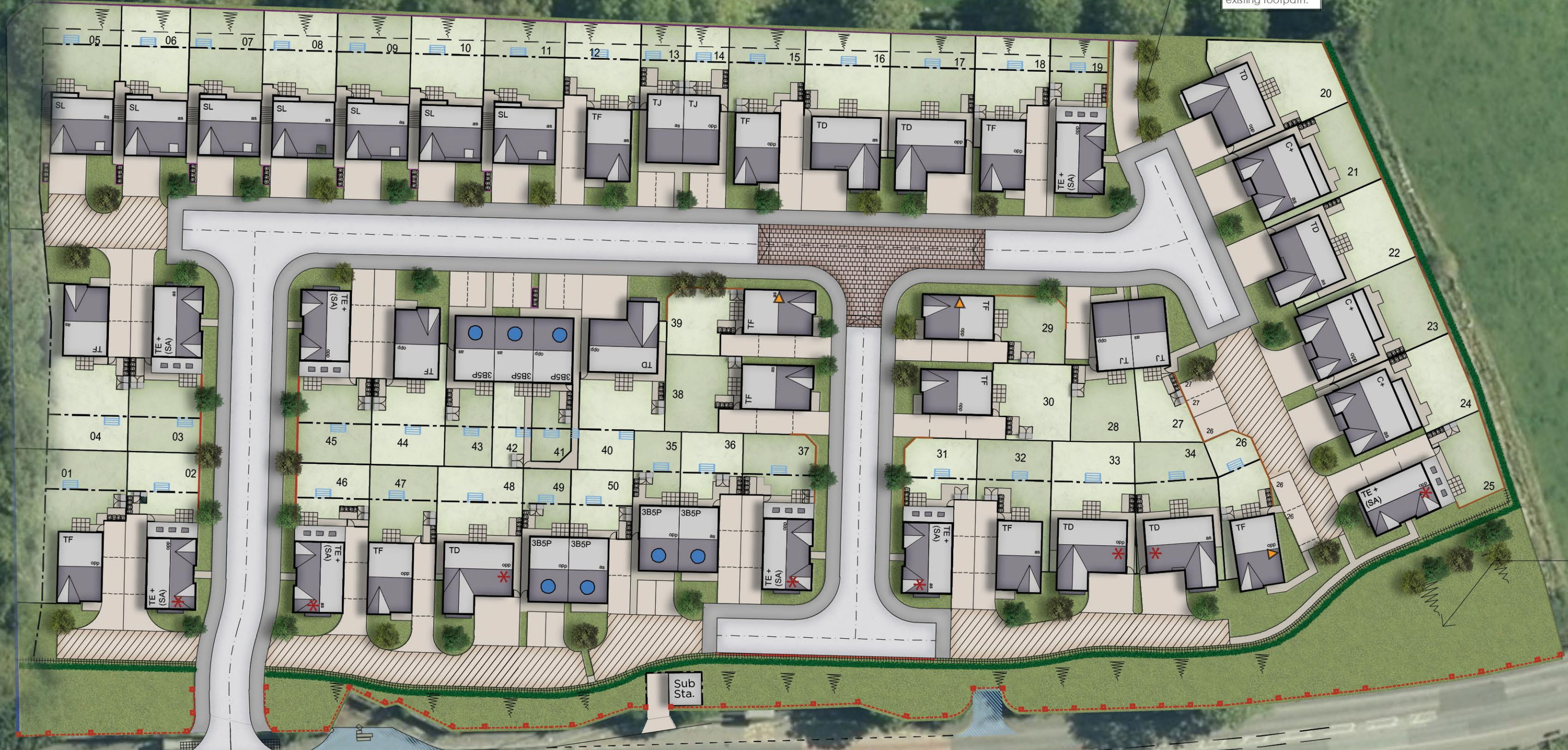

Potential area for stepped access to existing footpath.

Potential location of LAP.

Note: Drawing should be read in conjunction with the boundary treatment details, landscape layout and engineers drawings.